

## Tri-Head - Metric Machine Screws

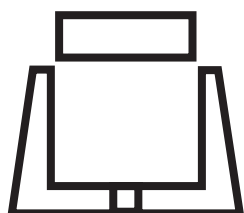

### Dimensions (mm)

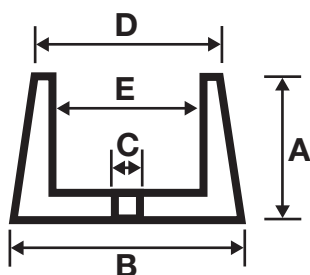

LENGTH / SIZE	A	B	C	D	E
M5	12.0	20.0	5.4	18.0	12.9
M6	13.0	22.0	6.4	20.0	15.0
M8	14.0	28.4	8.4	26.0	20.0
M10	18.0	31.8	10.4	30.0	25.3
M12	20.0	35.8	12.4	32.0	26.5

### Material and Finish

**Material:** EN1A Steel  
**Heat Treatment:** Case Hardened  
**Finish:** Bright Zinc Plated 3µm

### Size & Part Numbers

LENGTH / GAUGE	M5	M6	M8	M10	M12
STOCK	NG05T1	NG06T1	MG08T1	MG10T1	MG12T1

### Additional Information

**Patented Product:** Hafren Fasteners  
**Installation:** Nogo™ - see video  
**Removal:** 1-Way Removable Screw



Every effort has been made to ensure the accuracy of information provided in this catalogue. Hafren Fasteners cannot warrant the information however, expressly or implied, and any liability arising from it is expressly excluded. Customers must satisfy themselves as to the suitability of products and the technical information relating to them, and it is recommended that you conduct your own tests to establish suitability. All sizes shown are in mm without min and max tolerances and are guide sizes. Hafren Fasteners reserve the right to change/alter sizes without notice. This does not effect your statutory rights.